

WATER / UTILITY SEPARATION CHART						
CROSSING	GROUND	WATER LINE		OTHER UTILITY		
		SIZE	DEPTH OF COVER	SIZE	DEPTH OF COVER	
A	271.2	12" DIP	5.0'	12" RCP	3.4'	1.5"
B	272.4	6" DIP	5.0'	8" PVC	7.2'	1.5"
C	273.2	6" DIP	5.0'	6" PVC	7.3'	1.6"
D	273.1	6" DIP	5.0'	36" ADS	2.5'	1.5"
E	275.4	6" SERVICE	5.0'	12" ADS	3.7'	1.5"
F	279.0	6" DIP	5.0'	10" ADS	3.6'	1.5"
G	279.6	6" DIP	5.0'	6" PVC	8.2'	2.6"
H	282.9	6" DIP	5.0'	6" PVC	7.4'	1.7"
I	283.3	6" DIP	5.0'	10" ADS	4.3'	1.5"
J	284.3	6" DIP	5.0'	6" PVC	9.2'	3.5"
K	284.0	6" DIP	5.0'	8" PVC	9.9'	4.2"
L	285.3	6" SERVICE	5.0'	8" PVC	9.6'	4.1"
M	284.7	6" DIP	5.0'	12" ADS	3.6'	1.5"
N	283.0	6" DIP	5.0'	10" ADS	4.2'	1.5"
O	282.3	6" SERVICE	5.0'	8" PVC	9.5'	4.0"
P	281.1	6" DIP	5.0'	18" ADS	2.8'	1.5"
Q	279.2	6" DIP	5.0'	8" PVC	8.1'	2.4"
R	279.1	6" DIP	5.0'	10" ADS	4.0'	1.5"
S	278.6	6" SERVICE	5.0'	8" PVC	7.8'	2.3"
T	277.7	6" DIP	5.0'	18" ADS	2.9'	1.5"
U	275.1	6" SERVICE	5.0'	8" PVC	7.2'	1.7"

UTILITY SCHEDULE		
UTILITY	SIZE	QUANTITY
SEWER MAIN	8"	1,332 L.F.
SEWER LATERAL	6"	270 L.F.
SEWER MANHOLE	N/A	12
WATER MAIN	12"	27 L.F.
WATER MAIN	8"	1,478 L.F.
WATER SERVICE	6"	286 L.F.
WATER MANHOLE	N/A	1
HYDRANT	N/A	2

NO.	DATE	REVISION

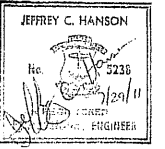

**ILLSTONE ENGINEERING, P.C.**  
 CIVIL ENGINEERING • LANDSCAPE ARCHITECTURE • LAND PLANNING  
 250 CENTREVILLE ROAD, BUILDING #12, WARWICK, RHODE ISLAND 02886, P. (401) 921-3344, F. (401) 921-3303

UTILITY PLAN

TIFFANY VILLAGE

A.P. 16, LOT 3  
 NEW LONDON TURNPIKE  
 COVENTRY, RI

PREPARED FOR:  
**SHERWOOD DEVELOPMENT, LLC**

1" = 40'  
 JULY 2011

Drawn By: B.J.C.  
 Checked By: J.C.H.  
 Sheet

**5**  
 of 15

FILE NO.: 11.12.15

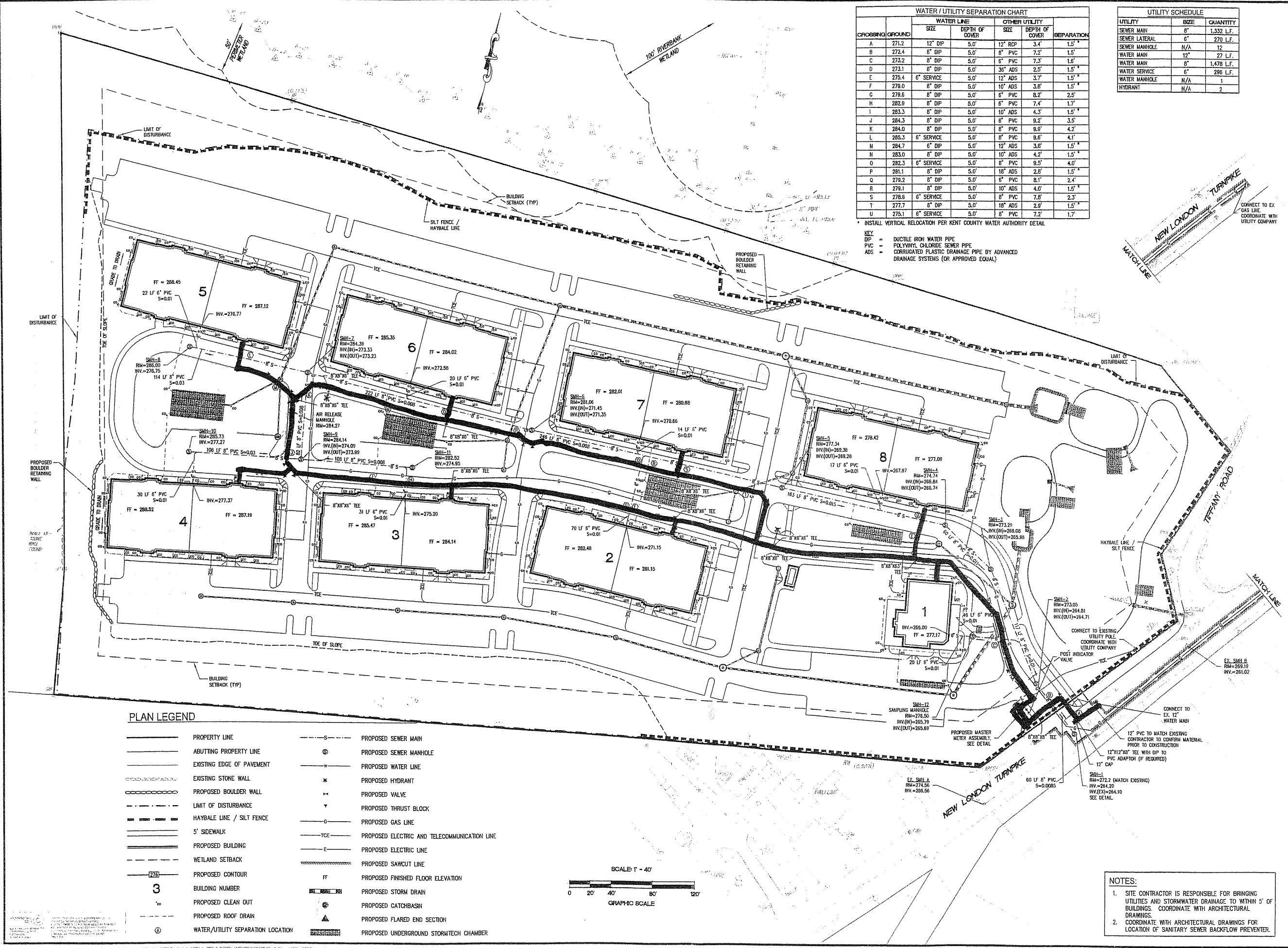

PLAN LEGEND	
	PROPERTY LINE
	ABUTTING PROPERTY LINE
	EXISTING EDGE OF PAVEMENT
	EXISTING STONE WALL
	PROPOSED BOULDER WALL
	LIMIT OF DISTURBANCE
	HAYBALE LINE / SILT FENCE
	5' SIDEWALK
	PROPOSED BUILDING
	WETLAND SETBACK
	PROPOSED CONTOUR
	BUILDING NUMBER
	PROPOSED CLEAN OUT
	PROPOSED ROOF DRAIN
	WATER/UTILITY SEPARATION LOCATION
	PROPOSED SEWER MAIN
	PROPOSED SEWER MANHOLE
	PROPOSED WATER LINE
	PROPOSED HYDRANT
	PROPOSED VALVE
	PROPOSED THRUST BLOCK
	PROPOSED GAS LINE
	PROPOSED ELECTRIC AND TELECOMMUNICATION LINE
	PROPOSED ELECTRIC LINE
	PROPOSED SAWCUT LINE
	PROPOSED FINISHED FLOOR ELEVATION
	PROPOSED STORM DRAIN
	PROPOSED CATCHBASIN
	PROPOSED FLARED END SECTION
	PROPOSED UNDERGROUND STORMTECH CHAMBER

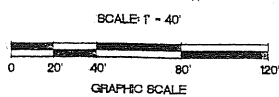

**NOTES:**  
 1. SITE CONTRACTOR IS RESPONSIBLE FOR BRINGING UTILITIES AND STORMWATER DRAINAGE TO WITHIN 5' OF BUILDINGS. COORDINATE WITH ARCHITECTURAL DRAWINGS.  
 2. COORDINATE WITH ARCHITECTURAL DRAWINGS FOR LOCATION OF SANITARY SEWER BACKFLOW PREVENTER.